

**ED Series****Exterior Door for Walls and Ceilings**

Elmdor® Exterior Access Doors are manufactured and engineered to provide access to exterior applications ensuring years of protection against outdoor elements. Our new technology helps to manifest resistance to water and vapor. Our Exterior Door includes foam insulation and neoprene gasket on four sides.

**Door** is fabricated from 16 gage, galvanized steel with a prime coat finish and 1" thick rigid foam insulation.

**Frame** is fabricated from 16 gage, galvanized steel with a prime coat finish and provided with bolt holes.

**Hinge** is concealed and operates completely out of sight, so that only the door and frame are visible.

**Exterior latch** is a cylinder lock that features a knurled knob or key operation.

**Finish** is a prime coat suitable for painting.

**Guide Specification**

Provide Elmdor® ED Series, Exterior Access Doors (specify model number and options). Access door frame shall be fabricated from 16 gage galvanized steel with a prime coat finish and provided with bolt holes. Access door panel shall be fabricated from 16 gage galvanized steel with a prime coat finish. Door shall be filled with 1" thick, rigid foam insulation and neoprene gasket on four sides. Access door shall have a concealed hinge with exterior latching cylinder lock that features a knurled knob or key operation. Finish shall be prime coat suitable for painting

**[Click here to Online Product Page and Pricing](#)**



Member of U.S. Green  
Building Council

**ED**

Revised: 11/01/11



**MODEL NUMBER AND OPTIONS SELECTION****BASE MODEL NUMBER**☐ ED Exterior Door for Walls and Ceilings**Suffix Options**☐ - GB Galvanized Drywall Bead  
☐ - SS Stainless Steel Construction.  
(Type 304 No 4 Finish Satin Finish)**STANDARD AVAILABLE SIZES**

Special sizes available upon request.

NOMINAL DOOR SIZE (W x H)	WALL OPENING	LOCK QNTY	WEIGHT
ED 12" x 12"	12-3/8" x 12-3/8"	1	15 lbs.
ED 14" x 14"	14-3/8" x 14-3/8"	1	17 lbs.
ED 18" x 18"	18-3/8" x 18-3/8"	1	20 lbs.
ED 24" x 24"	24-3/8" x 24-3/8"	1	28 lbs.
ED 22" x 30"	22-3/8" x 30-3/8"	2	32 lbs.
ED 30" x 30"	30-3/8" x 30-3/8"	2	38 lbs.
ED 24" x 36"	24-3/8" x 36-3/8"	2	40 lbs.
ED 36" x 36"	36-3/8" x 36-3/8"	2	50 lbs.
ED 36" x 48"	36-3/8" x 48-3/8"	2	81 lbs.

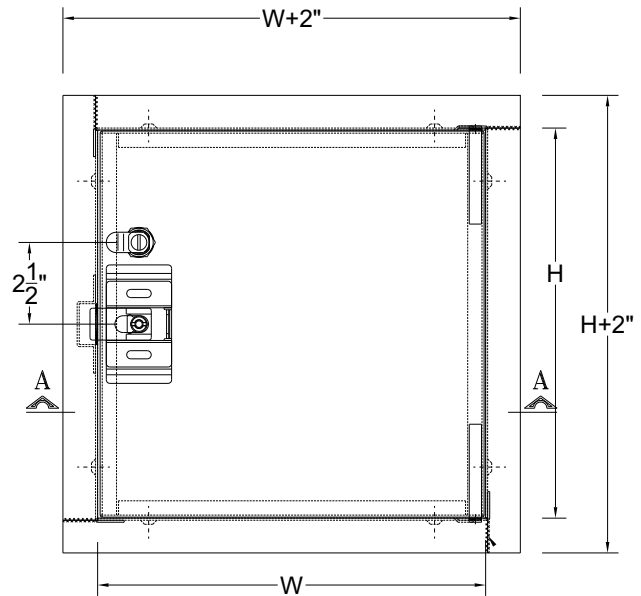
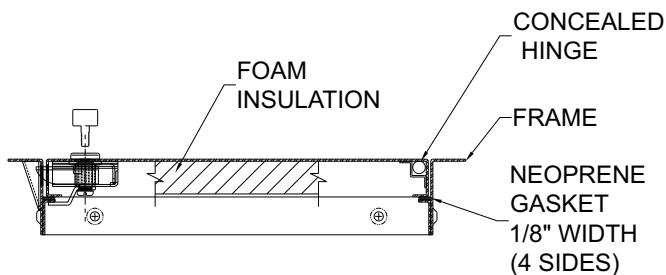
[Click here to Online Product Page and Pricing](#)**FRONT VIEW****SECTION A-A**KEY SHIPPED LOOSE  
TAPE TO BACK OF  
DOOR.**SELECTION SUMMARY & APPROVAL FOR MANUFACTURING**

Model Number & Options	Quantity
Company	Date
Contact	Title
Approval for Manufacturing/Signature	

**ED**

Revised: 11/01/11